

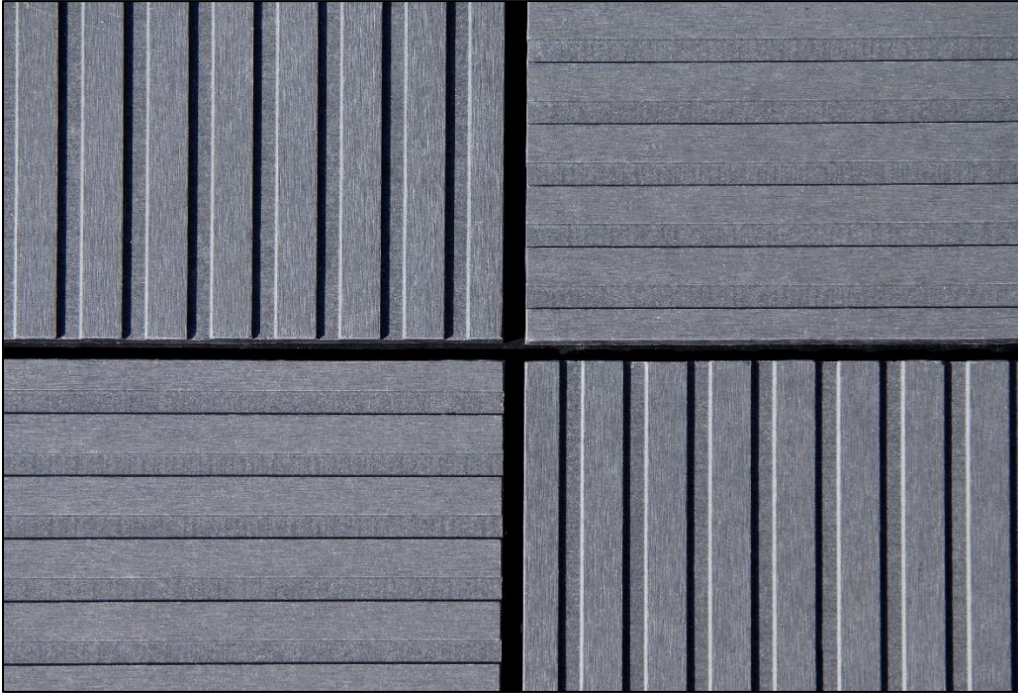

Patina – Inline Standard Installation Guidelines

General Notes

- Panel Orientation: Patina-Inline can be installed in the vertical or horizontal orientation.



- Visible Fastener Placement: Fasteners (screws and rivets) must be placed on 9.5mm thick non-grooved portion of the board. See page one of the Patina-Inline datasheet for thickness specifications. For corner hole placement, figure C in AFCC's Standard Wood, Steel, and Aluminum guidelines must be used.





Installation on Steel and Aluminum

For installation of Patina Inline onto Steel or Aluminum profiles, AFCC's Standard Installation Guidelines must be used.

Standard Installation Guidelines – Steel Profiles with Rivets

- https://www.americanfibercement.com/wp-content/uploads/2019/10/Install_STEEL_2019_AFCC.pdf

Standard Installation Guidelines – Aluminum Profiles with Rivets

- https://www.americanfibercement.com/wp-content/uploads/2019/10/Install_ALUMINUM_2019_AFCC.pdf

The rivet used for Patina-Inline is slightly different due to the panel thickness being 9.5mm versus the standard 8mm. The collar of the rivet used to attach this panel is 11.75mm long. All other dimensions are the same and the installation of the rivets is also the same. See the figure below.

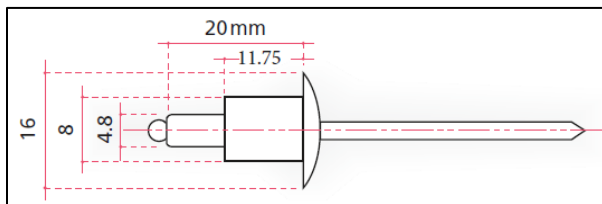

Patina-Inline Rivet Dimensions

Installation on Wood

For installation of Patina Inline onto wood profiles, AFCC's Standard Installation Guidelines must be used. The screw shown in these guidelines must also be used.

Standard Installation Guidelines – Wood Profiles with Screws

- https://www.americanfibercement.com/wp-content/uploads/2019/10/Install_WOOD_2019_web.pdf

Dynamic Bond (Hidden Attachment)

For installation of Patina Inline onto Steel or Aluminum profiles, AFCC's Standard Adhesive Bonding Installation Guidelines in conjunction with the Steel, Aluminum, or Wood Standard Installation Guidelines.

- https://www.americanfibercement.com/wp-content/uploads/2018/09/DBS_Instructions-for-Use-Dynamic-Bond-Cembrit.pdf

